















# ALUMWOOD®

## AW 150 Series Installation Manual





## AW 150 System Components and Details

PROFILES	PROFILE NUMBER	DESCRIPTION	COLOR / FINISH	LENGTH	NUMBER OF PIECES PER BOX
	AW101	"J" Mould Starter Attachment	Wood Grain Colors or Solid Colors	18'-6"	16
	AW102A	Joint Attachment Cap	Wood Grain Colors or Solid Colors	18'-6"	22
	AW102B	Joint Attachment Base	Aluminum Mill Finish	18'-6"	16
	AW103A	Jamb Attachment Cap	Wood Grain Colors or Solid Colors	18'-6"	22
	AW103B	Jamb Attachment Base	Aluminum Mill Finish	18'-6"	20
	AW104B	Outside Corner Male Attachment Base	Aluminum Mill Finish	18'-6"	7
	AW104A	Outside Corner Female Attachment Cap	Wood Grain Colors or Solid Colors	18'-6"	8
	AW105	One Piece Inside Corner Attachment	Wood Grain Colors or Solid Colors	18'-6"	8
	AW106	Starter	Aluminum Mill Finish	18'-6"	20
	AW150	Shiplap Cladding 6" (150 mm) Exposure Profile. One Piece of AW150 with 18'-6" ft. length covers <b>9.10 sf.</b>	Wood Grain Colors or Solid Colors	18'-6"	6
	800 435	EDPM Gasket 3-1/4" per ft. (5 ft. per AW150 Shiplap Profile of 18'-6" length)	Black	5 ft. minimum recommended per 18'-6" of AW150	1640 feet / box
	AW107	Fixing Bracket (1" piece) <b>(1 piece per 16") 15 Pieces per AW150 Shiplap with 18'-6" length. *Number of fixing brackets can change according to design and conditions.</b>	Aluminum Mill Finish	1" piece	500 pieces

Visit [www.alumwood.com](http://www.alumwood.com) for detailed drawings and specifications.



## AW 150 System Components and Details

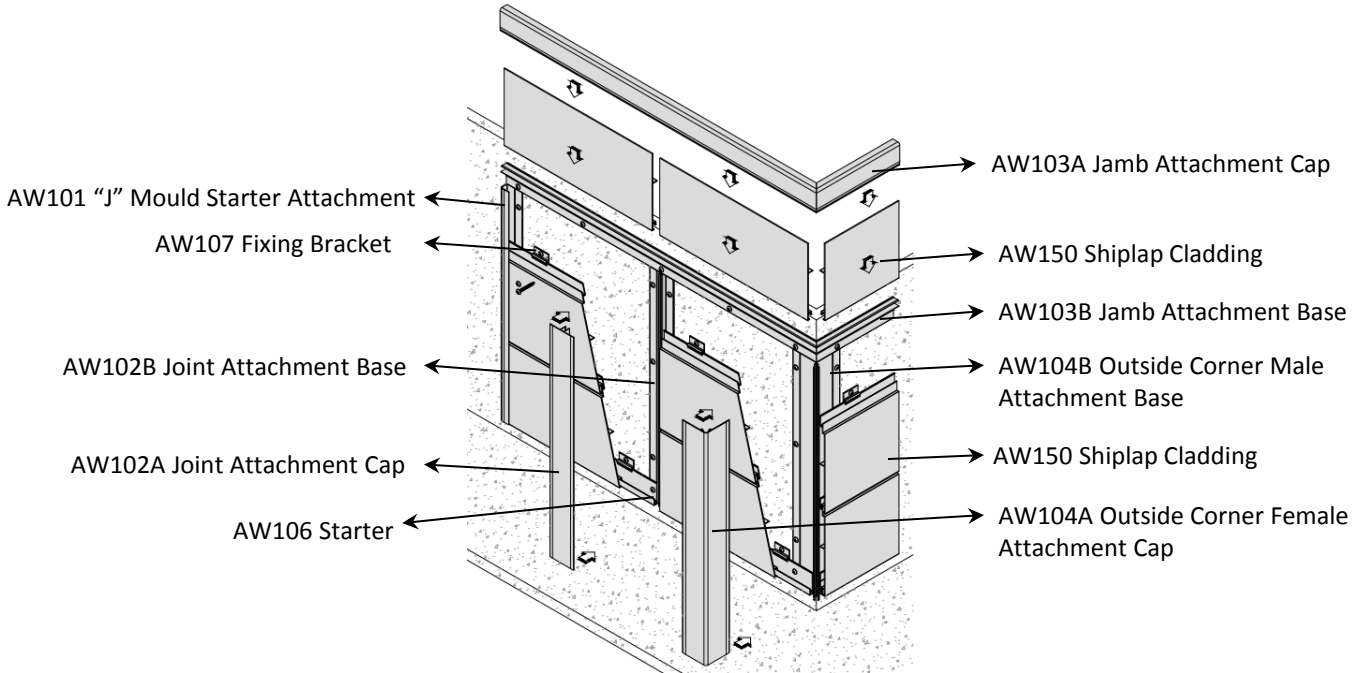

**Please read the installation guidelines completely.** ALUMWOOD® will not be responsible or liable under its written warranty for product failure caused by application that does not meet the requirements for proper installation. Before installation, always check the ALUMWOOD profiles, colors and make sure they are correct before starting your project.

Contractor or installer is responsible for ensuring the ALUMWOOD profiles are installed in accordance with this instruction manual and any applicable building codes. ALUMWOOD has no liability for either improper installation or personal injury resulting from improper use or installation.

### Safety

Always use the appropriate safety equipment to avoid any risk of injury. ALUMWOOD® recommends but not limited to use gloves, respiratory protection, long sleeves, pants and safety glasses. Refer to [www.osha.gov](http://www.osha.gov) for personal protective equipment information.



ALUMWOOD®

## Storage and Handling

ALUMWOOD comes in carton boxes, profile lengths are 18'-6". Always store carton boxes on a flat clean surface in the warehouse or on jobsite. If there is no covered area on the jobsite, keep the boxes on an elevated surface that allows air flow underneath the boxes. And keep dry.

Always carry ALUMWOOD boxes with two people and on the edge (not flat) to avoid injury and damage to product.

## Tools and Cutting

Use standard wood cutting tools for ALUMWOOD such as mitre saw and table saw with carbide blade for non – ferrous metals. Always cut ALUMWOOD face up whenever possible and you can use touch-up pens to seal aluminum visible cut ends. Tap the face of the trim saw surface and table saw surface in order not to have marring and scratches.

## Fastening

ALUMWOOD is fastened by using AW107 Fixing Brackets. Standard application has 15 Pieces per AW150 Shiplap with 18'-6" length, this equates to use of AW107 Fixing Bracket every 16" through 18'-6". Number of fixing brackets can change according to design and conditions. AW107 Fixing Brackets create the rear ventilation plane (air gap) to allow the system to act as a rainscreen system and allow for movement caused by thermal expansion and contraction. Use a 1-1/2" length, #8 screw with corrosion resistance suitable for the application and climate. By use of fixing brackets the product can be removed, if required, without damage.





## Expansion and Contraction

ALUMWOOD is made up of aluminum therefore there will be  $\frac{3}{16}$ " expansion and contraction in 18'-6" in all directions for temperature difference of 54 F (30 C). Take into consideration the expansion and contraction while installing AW150 cladding panels and leave necessary gaps under the attachment caps (J- mould, joint, jamb, corner attachment caps) and this will prevent deformations on the panels due to expansion and contraction. Do not fix fasten ALUMWOOD with its trim accessories to allow expansion and contraction movements on profiles. Fix ALUMWOOD panel on mid point in order to prevent movement of panel.

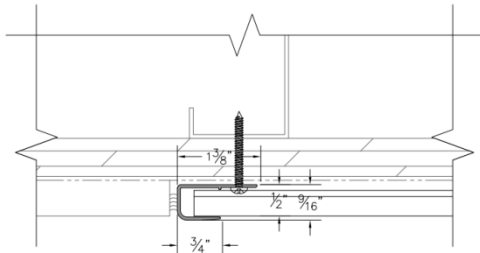

**AW101 "J" - Mould Starter Attachment**

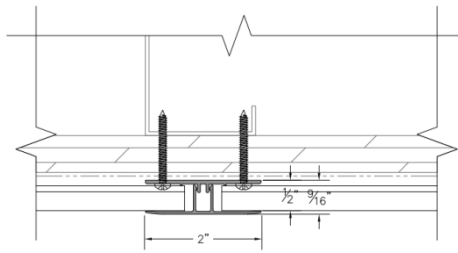

**AW102B Joint Attachment Base and  
AW102A Joint Attachment Cap**

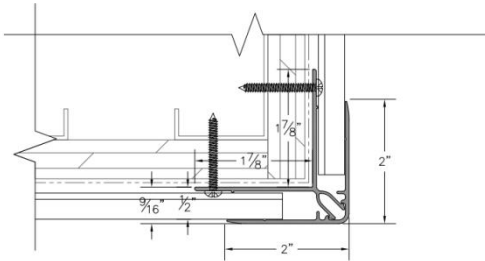

**AW104B Outside Corner Female Attachment Base  
and AW104A Outside Corner Male Attachment Cap**

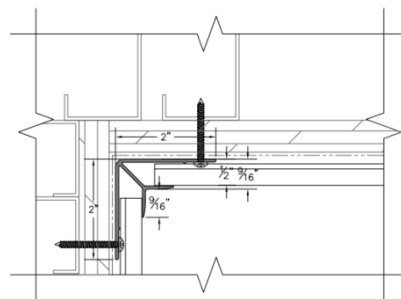

**AW105 One Piece Inside Corner Attachment**

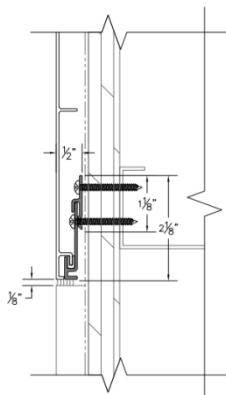

**AW106 Starter**

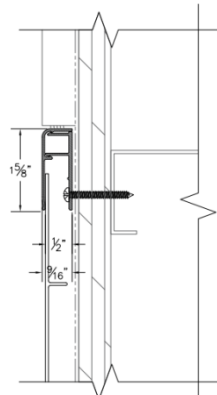

**AW103A Jamb Attachment Cap and  
AW103B Jamb Attachment Base**

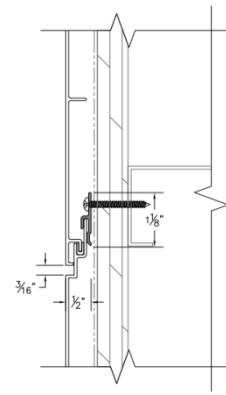

**AW107 Fixing Bracket**



## Installation

Clear the installation area of all debris and obstructions. Before installing ALUMWOOD, confirm that the moisture barrier is properly installed according to manufacturers' installation instructions.

**First** start with installing ALUMWOOD attachments with out caps ("J" Mould, Joint, Jamb, Outside Corner, Inside Corner, Starter). Always install AW106 Starter with AW107 Fixing Brackets that allow for proper ventilation gap, and direct fasten AW106 Starter to ensure required support to carry siding.

**Second** insert 800 435 EDPM gaskets minimum 3-1/4" per foot into the groove on top of AW150 Shiplap Cladding. A total of 5 foot are recommended per AW150 Shiplap Profile of 18'-6" length. EDPM gasket is used for decreasing wind vibration and noise.

**Third** insert AW150 Shiplap Cladding into the AW106 Starter. Ensure that the female side of the shiplap cladding is properly attached in the male side of AW106 Starter. After you confirm the lock in, push AW150 Shiplap cladding downward and in the meantime secure AW107 Fixing Bracket and fasten the board with fixing bracket and screw.

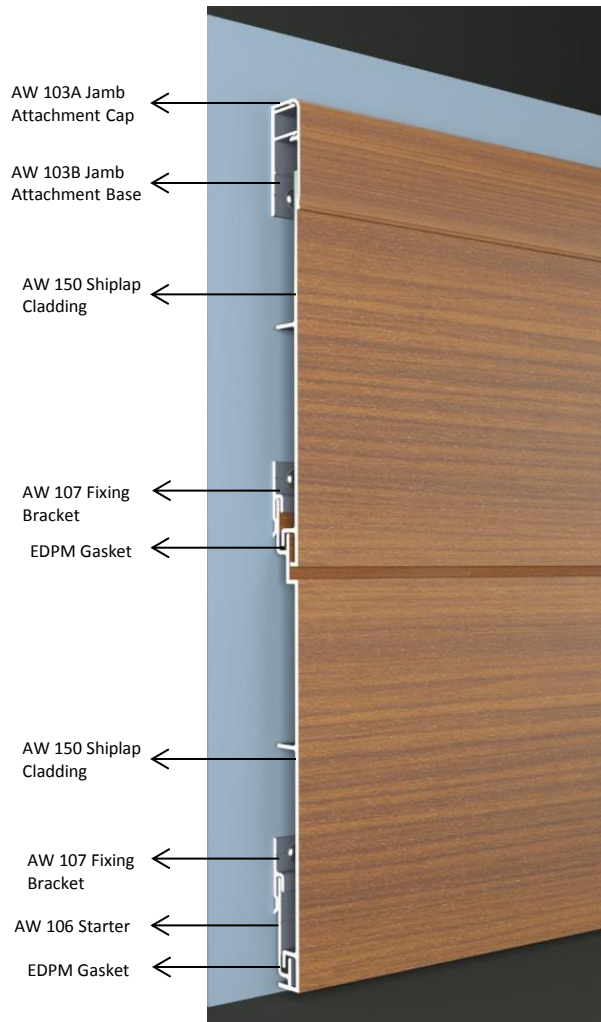



ALUMWOOD®

Continue with all the cladding until all required area is covered. Once the elevation is completed, direct fasten the AW103B Jamb Attachment Base and final piece of AW150 Shiplap Cladding. The final piece of shiplap cladding may need to be ripped. Check the width of the shiplap cladding and it should be at least 3-1/2" to be stable on the Jamb Attachment.

Finally attach all caps (Joint Attachment Cap, Jamb Attachment Cap. Use appropriate tool like a rubber hammer in order not to damage finishes to install caps.

### Care and Maintenance

ALUMWOOD does not need maintenance but may need cleaning as it is likely to collect dirt. You can wash ALUMWOOD by using a garden hose, **do not use power wash or pressure washers**. If necessary a mild cleaning agent (ph 6 – 7) may be added up to 10% maximum. DO not clean surfaces heated by the sun (>104F), quick drying process may cause blemishes. Do not use highly alkaline cleaning agents such as potassium hydroxide, sodium carbonate or caustic soda, and strong acid products or highly abrasive cleaning agents such as household cleaning products that corrode paint.



## Wood Grain Finish Color Codes



**TEAK**  
**AW 3181**



**GOLD OAK**  
**AW 5131**



**OAK**  
**AW 9111**



**DARK WALNUT**  
**AW 7163**



**AFROMOZYA TEAK**  
**AW 93093**



**LIGHT WALNUT**  
**AW 9310**



**LIGHT WENGE**  
**AW 9396**



**CHERY**  
**AW 9405**



**MAPLE**  
**AW 9510**



**DARK OAK**  
**AW 9391**



**PINE**  
**AW 2522**



**TILIA**  
**AW 7161**

## Solid Color Finish Color Codes



**AWS 616**



**AWS 617**



**AWS 620**



**AWS 625**



**AWS 906**



**AWS 913**



**AWS 935**



**AWS 939**



**AWS 967**

Product colors and availability are subject to change without notice, please call to verify.  
Special colors are available upon request and subject to minimum quantities.